

# TAC 750 E

**EN**

**OPERATING MANUAL**  
AIR CLEANER



## Table of contents

|   |   |
|---|---|
| Notes regarding the operating manual .....                    | 1 |
| Information about the device .....                            | 2 |
| Safety .....  | 3 |
| Transport and storage .....                                   | 4 |
| Technical data .....  | 3 |
| Operation .....   | 4 |
| Errors and faults .....                                       | 5 |
| Maintenance .....   | 5 |
| Disposal .....  | 7 |
| Overview and list of spare parts .....                        | 8 |
| Declaration of conformity (Translation of the original) ..... | 9 |

## Notes regarding the operating manual

### Symbols

**Danger!**

Warns of a hazard which can lead to injuries.

**Hazardous electric voltage!**

Warns of a hazard resulting from electric voltage which can lead to injuries.

**Caution!**

Warns of a hazard which can lead to damage to property.

**Note**

Indicates information regarding the application or general hints.

The current version of the operating manual can be found at:  
[www.trotec.de](http://www.trotec.de)

## Legal notice

This release replaces all previous versions. No part of this publication may be reproduced without written permission from TROTEC®. The same applies for electronically processing, duplicating or spreading the publication. Subject to technical changes. All rights reserved. Trademarks are used without guarantee that they may be used freely and primarily following the spelling of the manufacturer. Product names are registered. Changes to construction in the interests of constant improvements to the product, as well as changes to the shape and colour are reserved.

The scope of delivery may vary from product images. This document was created with all due care. TROTEC® accepts no liability whatsoever for possible mistakes or omissions.

© TROTEC®

## Information about the device

### Description of the device

Air cleaners are used to filter the room air. On building sites and renovation areas high concentrations of dust can arise, for instance when using angle grinders or during blasting, chiselling or demolition operations as well as when mixing dry mortar or tile cement.

The air is conveyed through the air intake opening (10) via the filters. The air filtered this way can stream back outside via the air outlets (4) at the sides and on top.

### Filter types (not included in the scope of delivery)

The following air filters are geared to the device and come with the largest possible filter surface based on the geometric dimensions. Consequently, a high air flow rate is achieved.

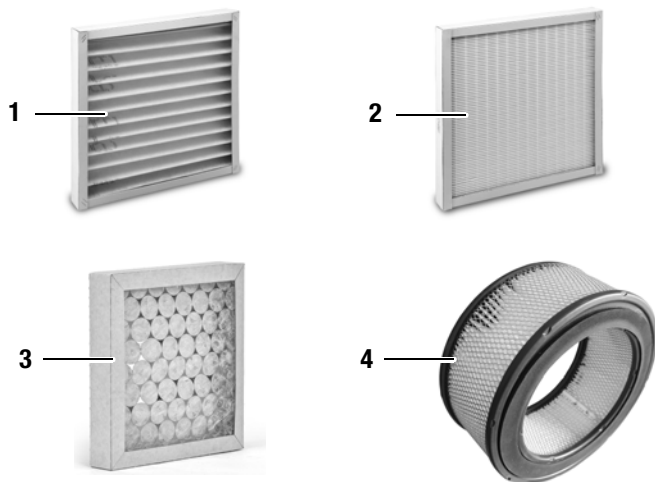

| No. | Designation                                       |
|-----|---|
| 1   | G4 Z line filter                                  |
| 2   | Pleated filter F7                                 |
| 3   | G3 spray paint filter                             |
| 4   | H13 high-efficiency particulate air filter (HEPA) |

### Note:

Please observe that only one prefilter (1, 2 or 3) can be implemented in a device at a time. Operation without prefilter is not advisable, for otherwise the fan could be damaged and the lifetime of the high-efficiency particulate air filter (4) is reduced.

## Device depiction

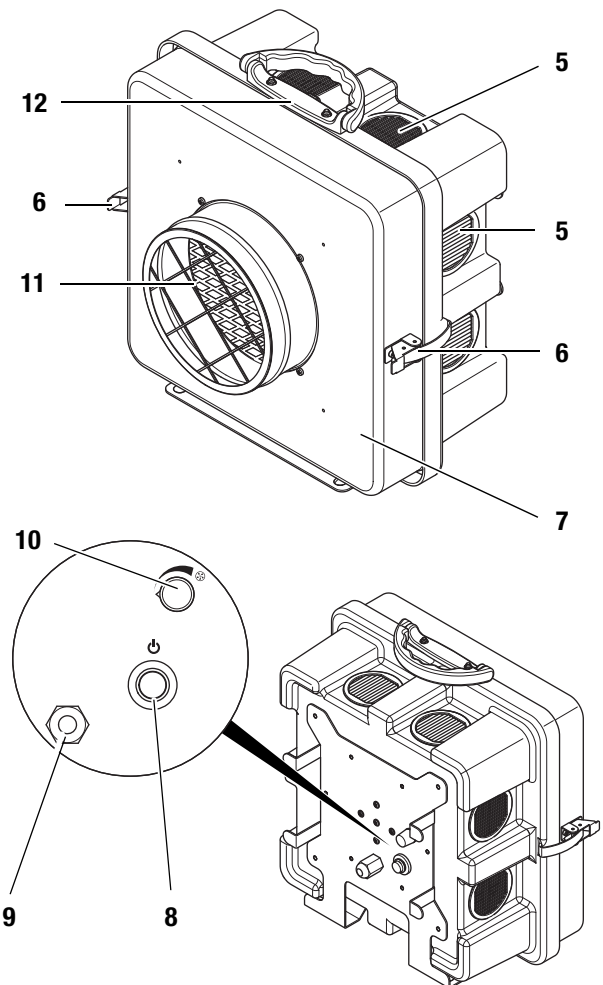

| No. | Designation            |
|-----|------------------------|
| 4   | Air outlet             |
| 5   | Air outlet             |
| 6   | Tension lock           |
| 7   | Front cover            |
| 8   | On/off switch          |
| 9   | Power cable connection |
| 10  | Speed controller       |
| 11  | Air intake opening     |
| 12  | Transport handle       |

**Technical data**

| Parameter                            | Value                    |
|--------------------------------------|--------------------------|
| Model                                | TAC 750 E                |
| Max. air volume without filter       | 750 m <sup>3</sup> /h    |
| Max. air volume with G4 filter       | 680 m <sup>3</sup> /h    |
| Max. air volume with G4 + H13 filter | 290 m <sup>3</sup> /h    |
| Power input                          | 0.120 kW                 |
| Input voltage                        | 230 V / 50/60 Hz         |
| Sound level (1 m)                    | 78 dB(A)                 |
| Dimensions (length x width x height) | 430 mm x 315 mm x 430 mm |
| Max. weight empty/filled             | 6.0/7.5 kg               |

**Accessories and supplies**

| Item  | Article number |
|---|----------------|
| G3 spray paint filter                             | 7160000416     |
| G4 Z-line filter                                  | 7160000404     |
| F7 pleated filter                                 | 7160000409     |
| H13 high-efficiency particulate air filter (HEPA) | 7160000220     |

| Item                               | Article number |
|------------------------------------|----------------|
| Air transport hose Tronect SP-T203 | 6100001200     |
| Hose/pipe adapter (Ø123)           | 6100010010     |
| Air transport hose Tronect TF-L127 | 6100001120     |
| Extension cable                    | 7333000376     |

**Safety**

**Carefully read the operating manual before using the device and keep it within reach!**

- Do not use the device in potentially explosive rooms.
- Do not use the device in atmospheres containing oil, sulphur, chlorine or salt.
- Only put up the device in a stable position on firm ground.
- Provide appropriate weather protection.
- Keep air inlets and outlets clear.
- Never insert objects into the device.
- Do not cover or transport the device during operation.
- Never use the device as storage place or footstep.
- Ensure that all electric cables outside of the device are protected from damage (e.g. from animals).
- Only use extensions to the connecting cable which are appropriate to the device power consumption, the length of its cable and its use. Avoid electrical overload.
- Dispose of replaced filters properly.

- Do not remove any safety signs, stickers or labels from the device. Keep all safety signs, stickers and labels in legible condition.
- Observe the storage and operating conditions (see chapter Technical data).

**Intended use**

Only use the device to clean atmospheric air from non-conducting and non-combustible dusts or suspended matter whilst adhering to the technical data.

**Improper use**

Do not use the device in potentially explosive areas. Do not place the device on damp or flooded ground. Do not use the device to siphon off vapours or fluids. Any unauthorised changes, modifications or alterations to the device are forbidden.

**Personnel qualifications**

People who use this device must:

- be aware of the dangers that occur when working with electric devices in damp areas.
- have read and understood the operating manual, especially the Safety chapter.

**Residual risks**



**Hazardous electric voltage!**

Work on the electrical components must only be carried out by electrically skilled persons!



**Hazardous electric voltage!**

Before any work on the device, remove the mains plug from the mains socket!



**Danger!**

Do not leave the packaging lying around. Children may use it as a dangerous toy!



**Danger!**

This appliance is not a toy! Children must be kept away from the device.



**Danger!**

Dangers can occur at the device when it is used by untrained people in an unprofessional or improper way. Observe the personnel qualifications.

## Transport and storage

### Transport

For easier transportation the device is equipped with a transport handle.

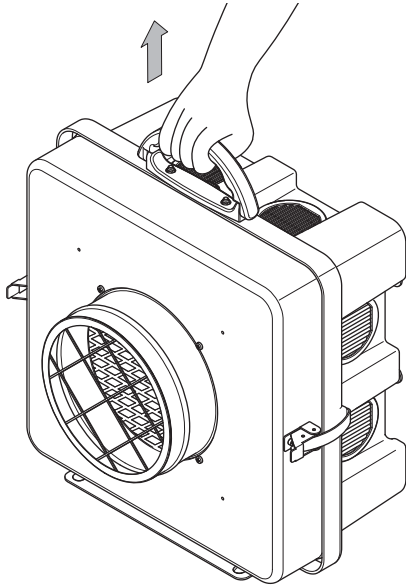

Before transporting the device, proceed as follows:

1. Switch off the device.
2. Disconnect the mains plug from the socket and coil up the cable. Do not use the power cable to drag the device!

### Storage

When the device is not being used, observe the following storage conditions:

- Dry,
- Protected from dust and direct sunlight,
- With a plastic cover to protect it from invasive dust, if necessary.

## Operation



### Caution!

In order to protect the device from damage, we recommend using it with at least one filter.

- Position the device near the source of air contamination or install the air hose at this source.
- Set the device in an upright and stable position.
- Do not create tripping hazards when laying the power cable or other electric cables.
- Make sure that no curtains or other objects interfere with the air flow.
- Make sure that extension cords are completely unrolled.

## Start-up

1. Completely unwind the power cable and connect it to a fused socket.

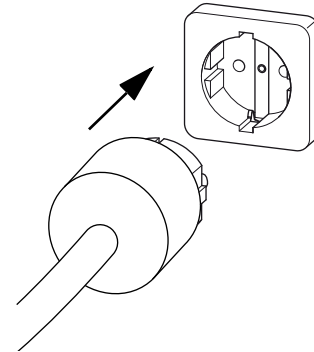

2. Press the On/Off switch (8).
  - The switch lights up in green.
  - The fan starts running after a delay.

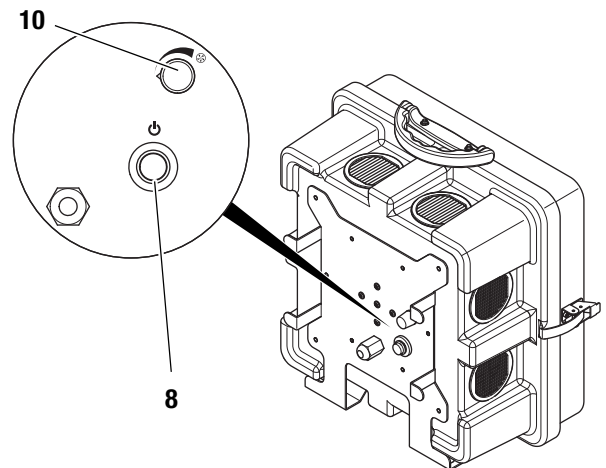

3. Adjust the speed controller (10) to the desired intensity level.

## Shutdown

1. Press the On/Off switch (8).
2. Remove the mains plug from the mains socket.
3. Clean the device according to chapter Maintenance.
4. Store the device according to chapter Storage.

**Errors and faults**

The accurate functionality of the device was tested during production a number of times. However, if functionality faults do occur, then check the device according to the following list.

**The device does not start:**

- Check the power connection (230 V AC /50 Hz).
- Check the mains plug for damages.
- Check the position of the speed controller.

**Your device still does not operate correctly after these checks?**

Please contact the TROTEC® customer service.



**Repair work which requires the housing to be opened must only be carried out by electrically skilled persons or by TROTEC®.**



**Maintenance**

**Activities required before starting maintenance**

- Do not touch the mains plug with wet or damp hands.



**Before opening the device, switch the device off and disconnect it from the mains.**



**Changing the filter**

1. Unlock both tension locks (5) at the left and right side of the device.
2. Remove the front cover (6) from the device.

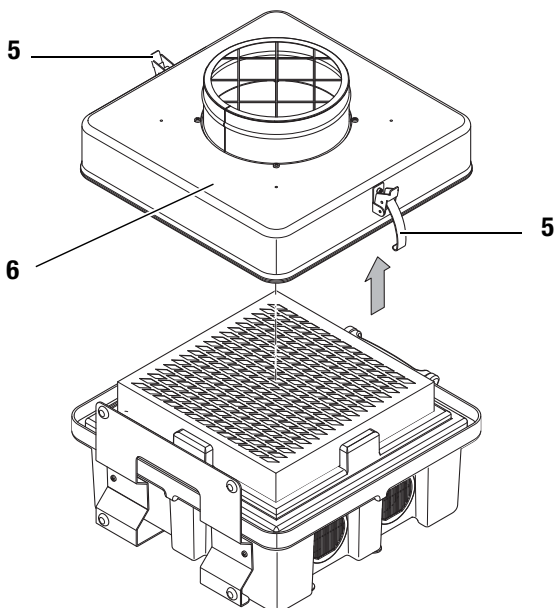

3. Remove the air filter.

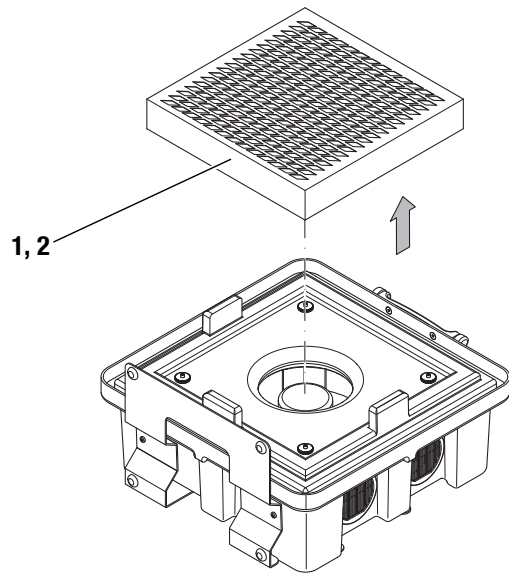

**Note**

If you only want to change this air filter, please continue with step 10.

If you want to exchange the HEPA filter as well, please continue with step 4.

4. Remove the four knurled screws (12).
5. Remove the cover (13) from the device.

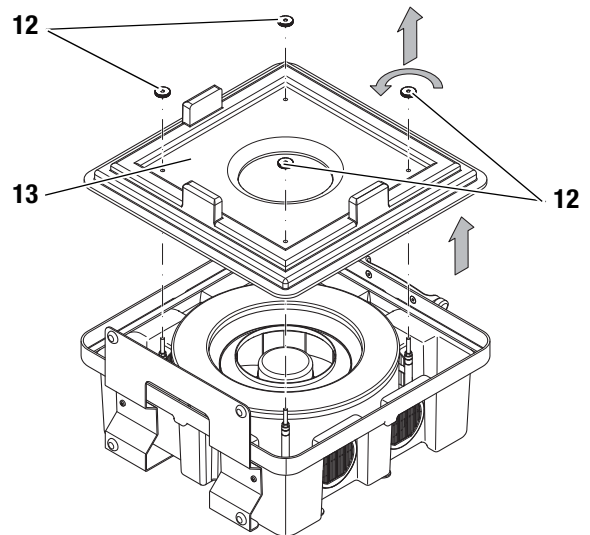

6. Remove the air filter (3).

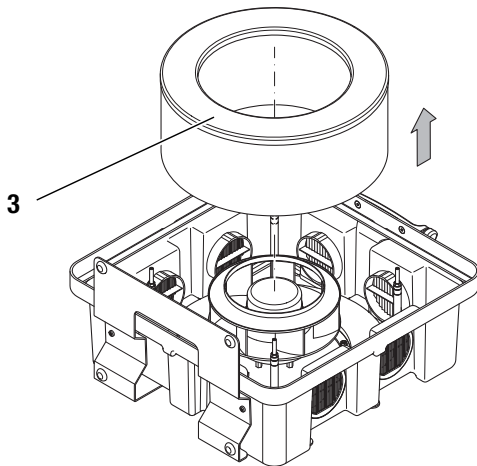

7. Install the new air filter (3).

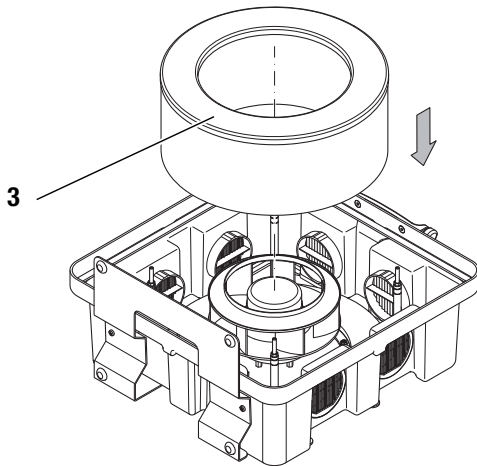

8. Put the cover (13) back on the device.

9. Affix the four knurled screws (12).

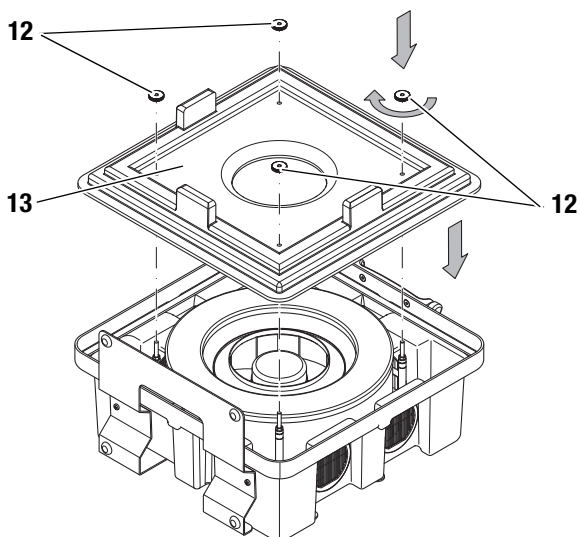

10. Install the new air filter. In doing so, pay attention to the correct alignment (front/rear).

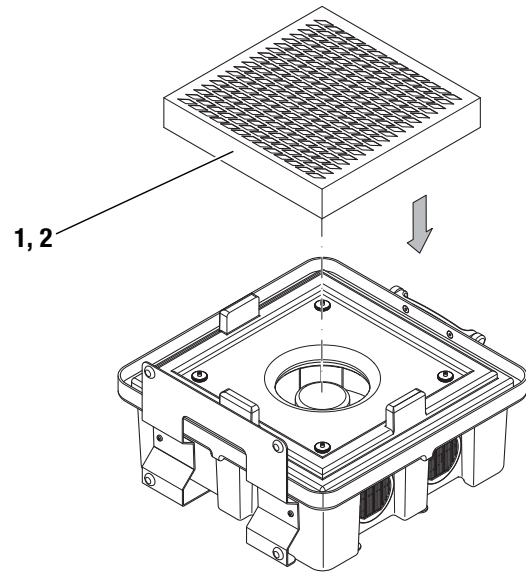

11. Put the front cover (6) back on the device.

12. Fasten the two lateral tension locks (5).

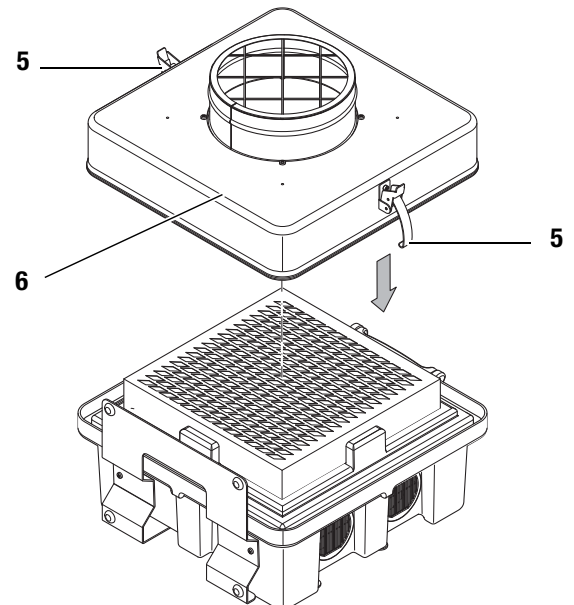



### Cleaning the housing

Clean the device with a soft, damp and lint-free cloth. Ensure that no moisture enters the housing. Do not use any sprays, solvents, alcohol-based cleaning agents or abrasive cleaners, but only clean water to moisten the cloth.

Do not use a high-pressure cleaner!

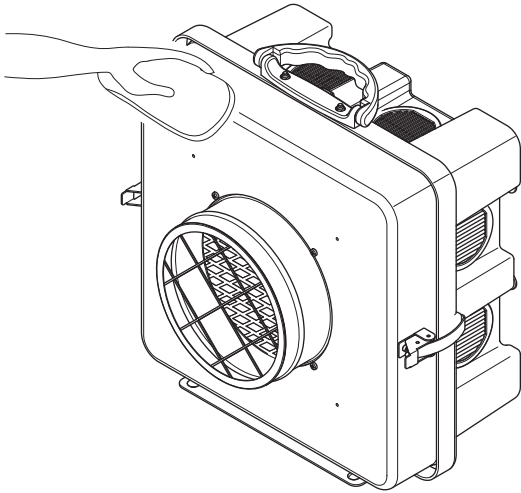

### Disposal



In the European Union, electronic equipment must not be treated as domestic waste, but must be disposed of professionally in accordance with Directive 2002/96/EC of the European Parliament and Council of 27th January 2003 concerning old electrical and electronic equipment. At the end of its life, please dispose of this device according to the valid legal requirements.



## Overview and list of spare parts

### Note!

The position numbers of the spare parts differ from those describing the positions of other parts mentioned in this operating manual.

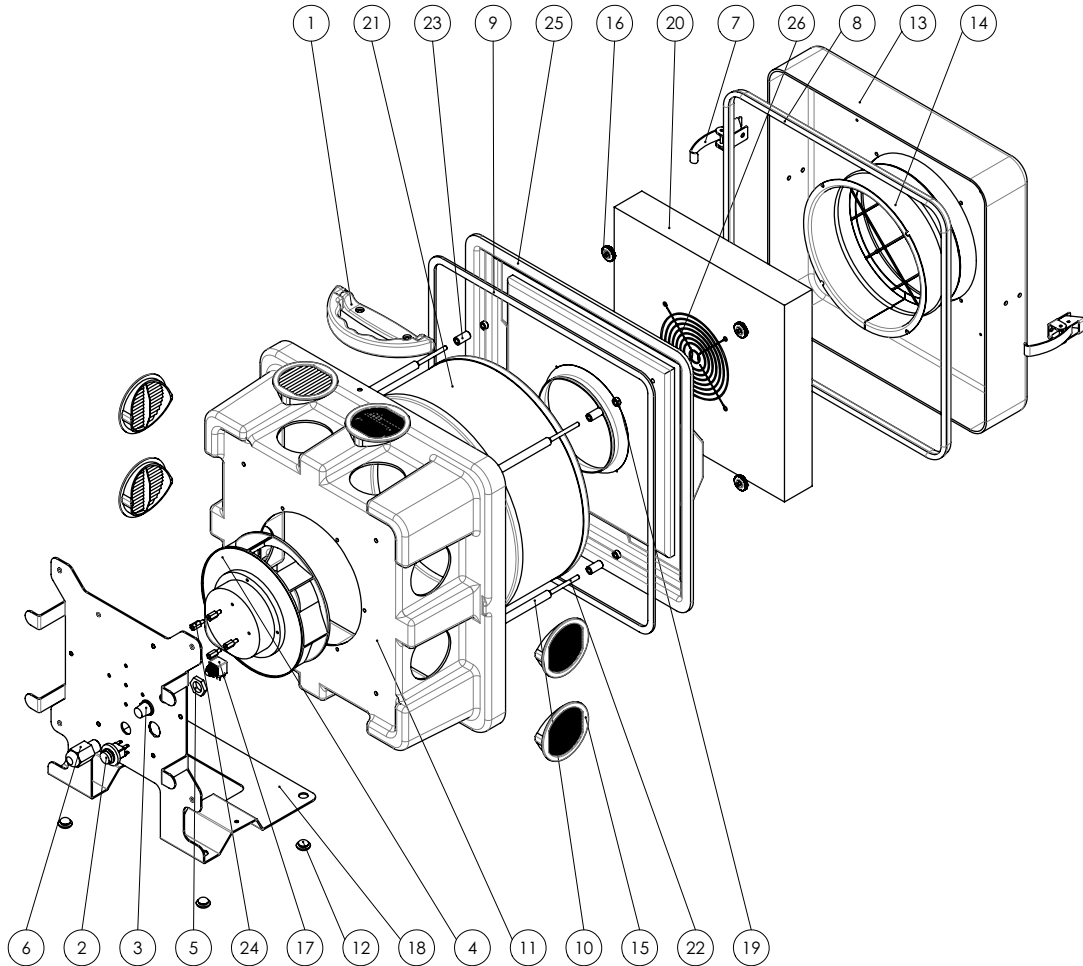

| No. | Spare part             | Art. no.  | No. | Spare part        | Art. no.  | No. | Spare part     | Art. no.   |
|-----|------------------------|-----------|-----|-------------------|-----------|-----|----------------|------------|
| 1   | handle                 | P10001246 | 10  | spacer sleeve     | P10001827 | 20  | air filter     | P10000619  |
| 2   | button                 | P10001376 | 11  | cover             | P10001839 | 21  | air filter     | 7160000220 |
| 3   | rotary button          | P10001250 | 12  | rubber buffer     | P10001843 | 22  | setscrew       | P10000469  |
| 4   | fan                    | P10000576 | 13  | bottom            | P10001838 | 23  | spacer sleeve  | P10001251  |
| 5   | lock nut               | P10001248 | 14  | fan shroud        | B1114     | 24  | spacer sleeve  | P10001555  |
| 6   | cable bushing          | P10001247 | 15  | plug              | B1140     | 25  | sandwich plate | P10001826  |
| 7   | spring tension element | P10000004 | 16  | nut               | P10000371 | 26  | finger guard   | P10000293  |
| 8   | gasket strip           | P10000002 | 17  | potentiometer     | P10001751 |     |                |            |
| 9   | gasket strip           | P10000003 | 18  | operating element | P10001827 |     |                |            |

**Declaration of conformity (Translation of the original)****EC Declaration of Conformity**  
in accordance with EC Machinery Directive 2006/42/EC**TROTEC® GmbH & Co. KG**Grebbener Straße 7  
D-52525 Heinsberg

herewith declares, that due to its design and construction, and in the version introduced by us, the following machinery conforms with the relevant fundamental requirements of the listed EC directives.

**Important note:**

In case of improper use, installation, maintenance etc. or unauthorized changes of the factory-supplied device version, this declaration loses its legal validity.

**Device version:** Air Cleaner**Series:** **TAC 750 E****Year of manufacture:** as of 09/2014**Applicable regulations:** 2006/42/EC Machinery Directive  
2004/108/EC EMC Directive  
2011/65/EC RoHS**Applied harmonised standards:** EN 60335-2-65:2003  
EN 55014-1:2006  
EN 13857:2008  
EN 60204-1:2006  
EN ISO 12100:2010

Producer and authorised representative of the technical documentation:  
Trotec GmbH & Co. KG · Grebbener Straße 7 · D-52525 Heinsberg  
Phone: +49 2452 962-400 · Fax: +49 2452 962-200 · E-mail: info@trotec.com

Heinsberg, 01/09/2014

Managing Director: Detlef von der Lieck



**Trotec GmbH & Co. KG**

Grebener Str. 7  
D-52525 Heinsberg

☎ +49 2452 962-400

☎ +49 2452 962-200

[info@trotec.com](mailto:info@trotec.com)

[www.trotec.com](http://www.trotec.com)